

| REVISIONS |                           |         |     |     |
|-----------|---------------------------|---------|-----|-----|
| LTR       | DESCRIPTION               | DATE    | DWN | APR |
| S1        | REVISED PER ECO-11-005294 | 05APR11 | RK  | HMR |

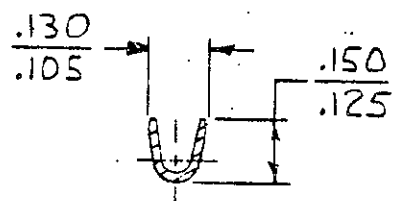

SECT A-A

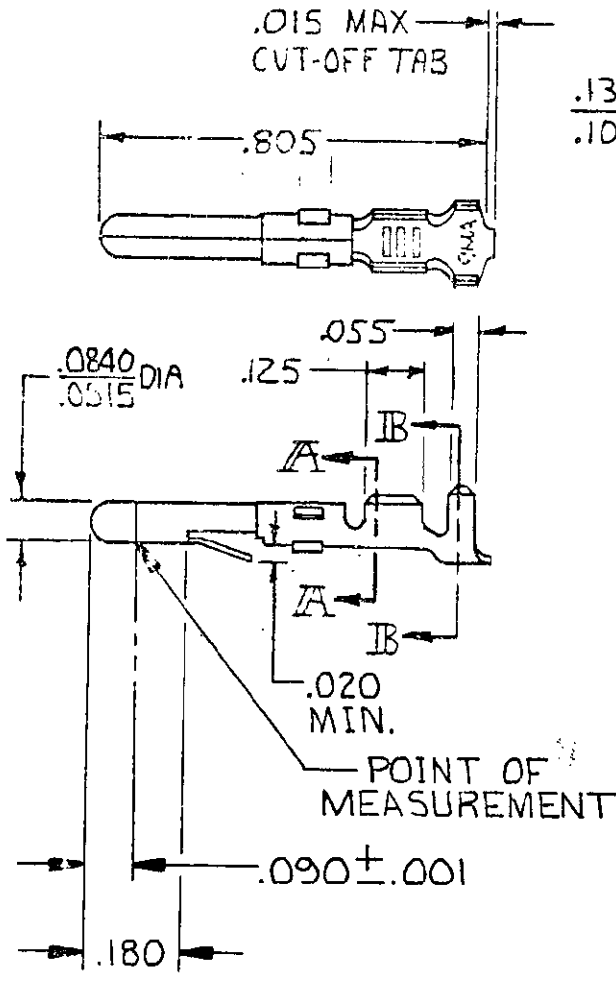
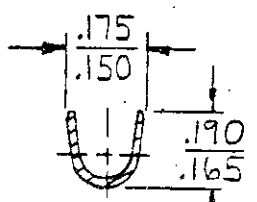

SECT B-B

⚠ .000030 GOLD INSIDE WIRE BARREL & ON TIP OF PIN & REMAINDER OF CONTACT IS NICKEL PLATE.

|         |            |         |
|---------|------------|---------|
| GOLD. ⚠ | .012 BRASS | 60620-5 |
| PRE-TIN | PLI. BRZ   | -4      |
| PRE-TIN | .012 BRASS | 60620-1 |
| FINISH  | MATERIAL   | PART NO |

UNLESS OTHERWISE SPECIFIED DIMENSIONS ARE IN INCHES. TOLERANCES ON: DECIMALS ±.015 ANGLES ±

CONTRACT NO  
DR *M. FEHER 11-26-79*  
CHK *J. S. Weide 11/1/80*

**STE** TE Connectivity

MATERIAL  
SEE TABLE

APPD *D. J. ... 1-7-81*  
APPD

NAME PIN, LOOSE PIECE, COMMERCIAL MATE-N-LOK

FINISH  
SEE TABLE

INSULATION DIA .130 MAX  
WIRE RANGE 20-14 AWG

SIZE **A** CODE IDENT NO **00779** DRAWING NO **60620**  
SCALE — SHEET —